

# Proposed Options for Marie Sharpe Site

---

1. School with attached full-sized Field House & Cultural Centre.
2. School with Cultural Centre & separate full-sized Field House.
3. School with half-sized Field House & attached Cultural Centre.
4. School with Open Field & attached Cultural Centre.
5. School with Open Field & separate Cultural Centre.

Option 1. School with attached full-sized Field House & Cultural Centre.

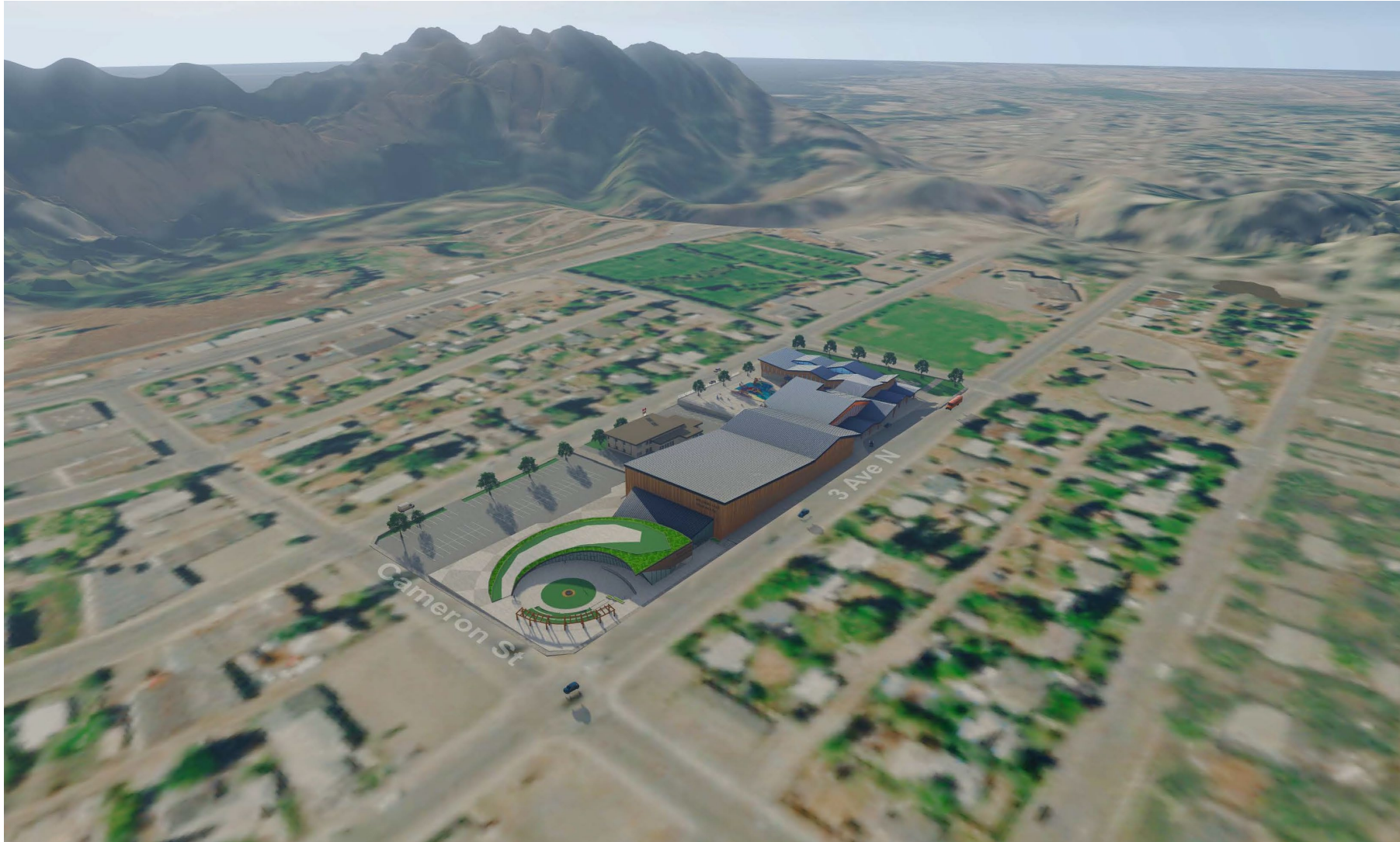

# WILLIAMS LAKE REPLACEMENT SCHOOL MARIE SHARPE SITE

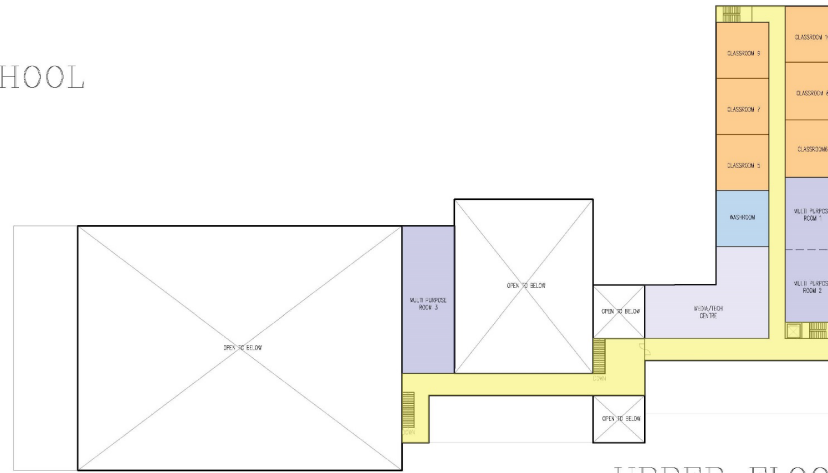
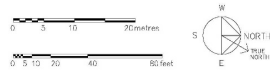

UPPER FLOOR PLAN

SECOND AVENUE NORTH

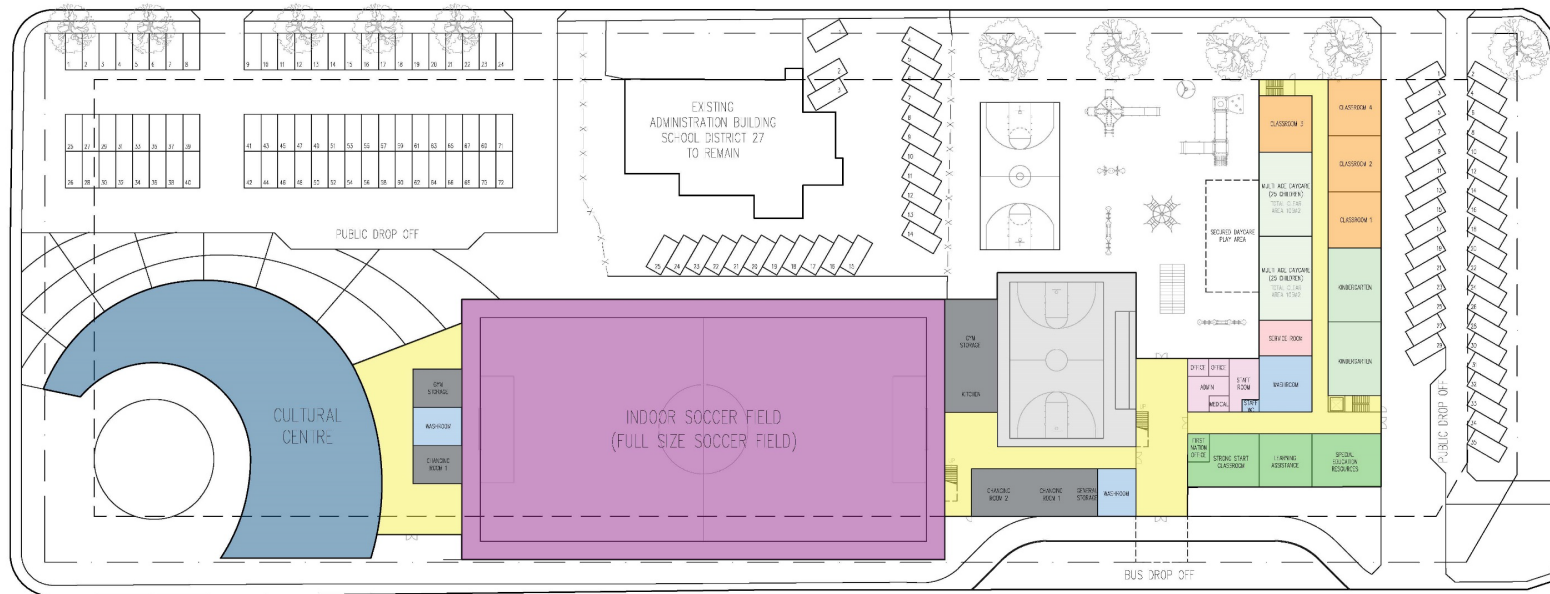

THIRD AVENUE NORTH

GROUND FLOOR PLAN



CHERNOFF THOMPSON  
ARCHITECTS

Marie Sharpe Replacement School + full-sized Fieldhouse w/Cultural Centre  
FIELD HOUSE INTERIOR  
2023-05-31



CHERNOFF THOMPSON  
ARCHITECTS

Marie Sharpe Replacement School + full-sized Fieldhouse w/Cultural Centre  
VIEW OF OUTDOOR GATHERING PLACE FROM CULTURAL CENTRE  
2023-05-31



CHERNOFF THOMPSON  
ARCHITECTS

Marie Sharpe Replacement School + full-sized Fieldhouse w/Cultural Centre  
CULTURAL CENTRE  
2023-05-31

Option 2. School with Cultural Centre & separate full-sized Field House.



WILLIAMS LAKE REPLACEMENT SCHOOL  
MARIE SHARPE SITE

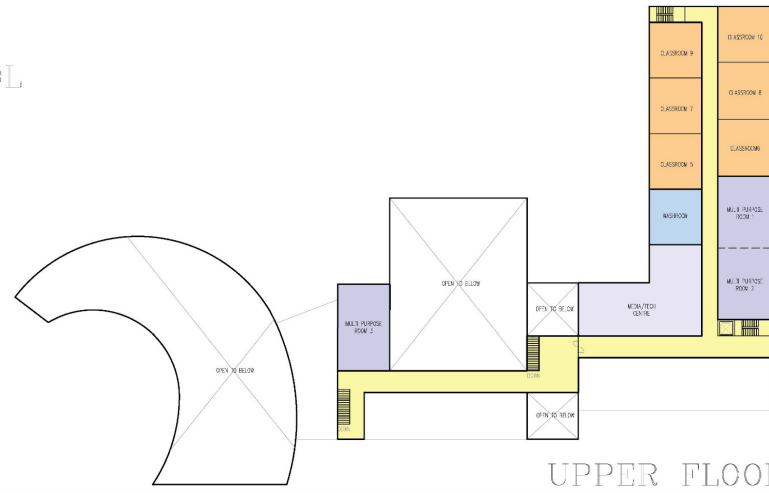
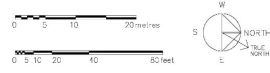

UPPER FLOOR PLAN

SECOND AVENUE NORTH

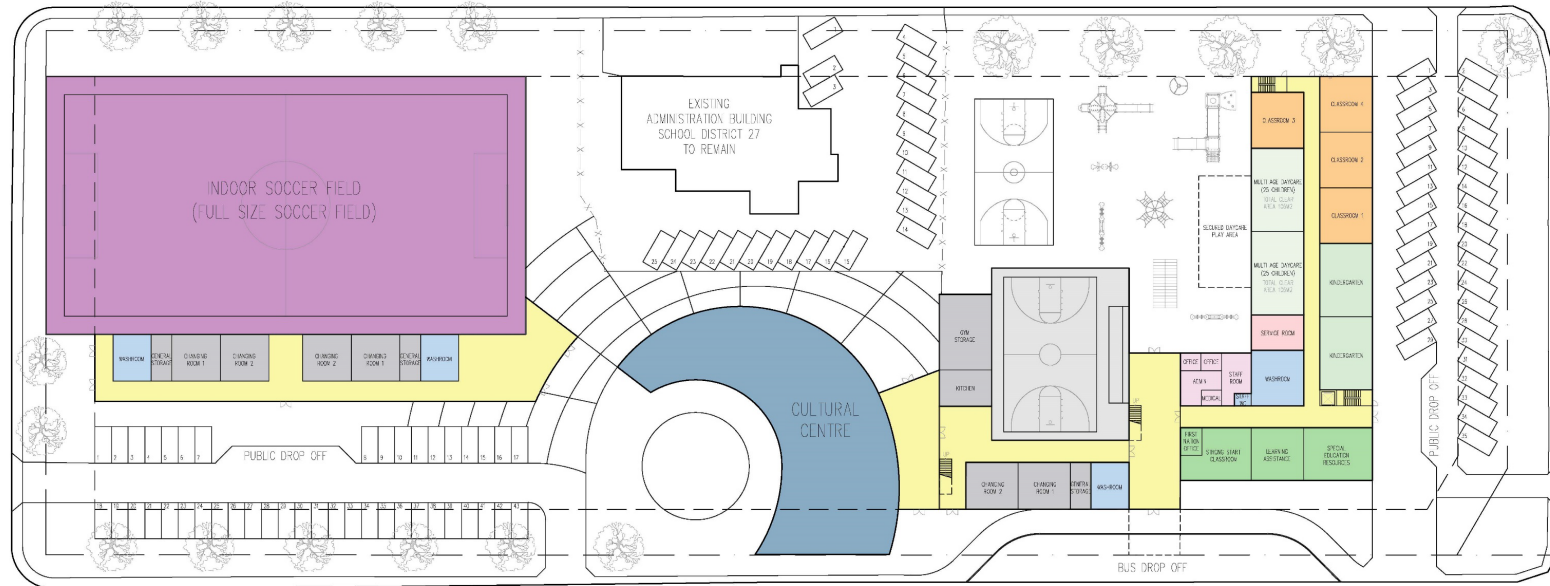

GROUND FLOOR PLAN

THIRD AVENUE NORTH



CHERNOFF THOMPSON  
ARCHITECTS

Marie Sharpe Replacement School + full-sized Fieldhouse w/Cultural Centre  
FIELD HOUSE INTERIOR  
2023-06-09



CHERNOFF THOMPSON  
ARCHITECTS

Marie Sharpe Replacement School + full-sized Fieldhouse w/Cultural Centre  
VIEW OF OUTDOOR GATHERING PLACE FROM CULTURAL CENTRE  
2023-06-09



CHERNOFF THOMPSON  
ARCHITECTS

Marie Sharpe Replacement School + full-sized Fieldhouse w/Cultural Centre  
CULTURAL CENTRE  
2023-06-09



CHERNOFF THOMPSON  
ARCHITECTS

Marie Sharpe Replacement School + full-sized Fieldhouse w/Cultural Centre  
FIELD HOUSE ENTRY GALLERY  
2023-06-09

Option 3. School with half-sized Field House & attached Cultural Centre.





# WILLIAMS LAKE REPLACEMENT SCHOOL MARIE SHARPE SITE

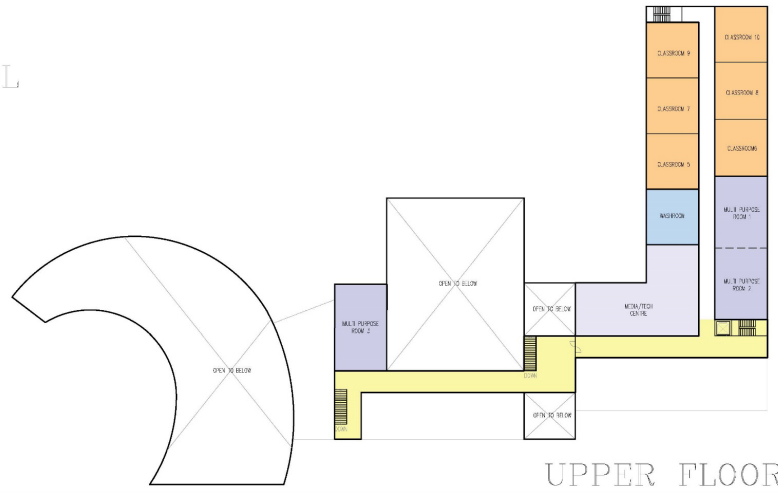
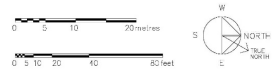

SECOND AVENUE NORTH

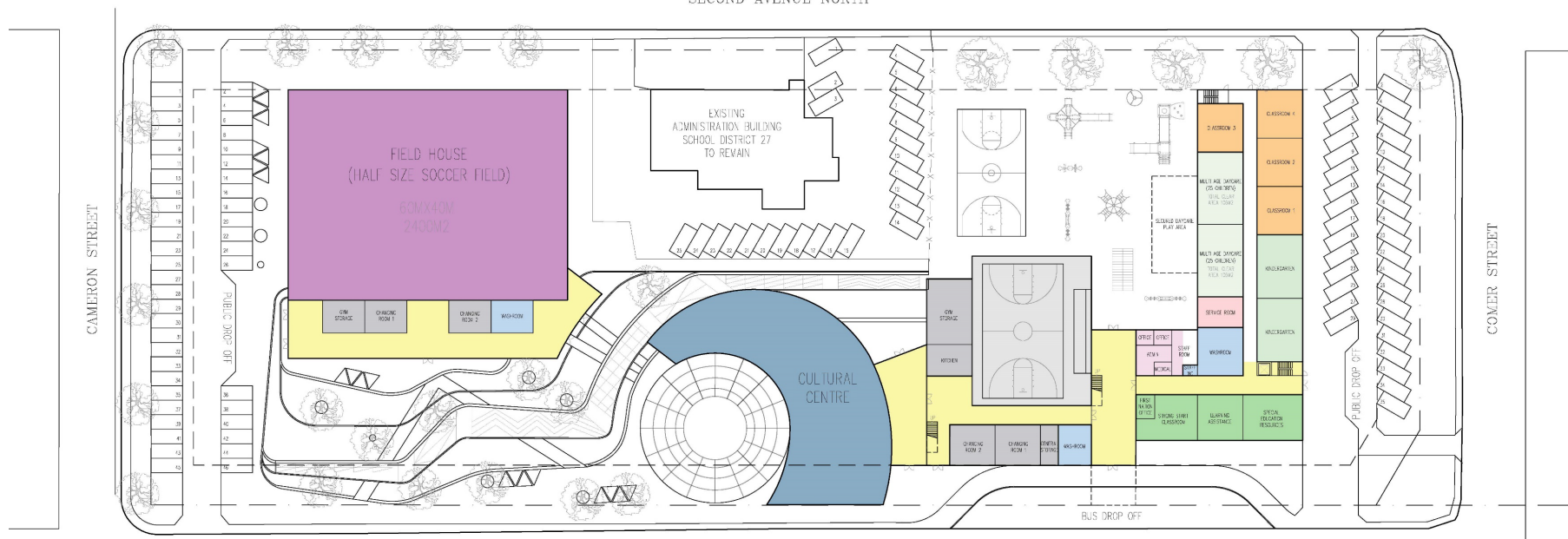

THIRD AVENUE NORTH

**GROUND FLOOR PLAN**



CHERNOFF THOMPSON  
ARCHITECTS

Marie Sharpe Replacement School + Cultural Center w/Half-Sized Field House - Option 3  
MASTER PLAN  
2023-07-11



CHERNOFF THOMPSON  
ARCHITECTS

Marie Sharpe Replacement School + Cultural Center w/Half-Sized Field House - Option 3  
WEAVING GARDEN  
2023-07-11



CHERNOFF THOMPSON  
ARCHITECTS

Marie Sharpe Replacement School + Cultural Center w/Half-Sized Field House - Option 3  
ROOF GARDEN + GATHERING PLACE + WEAVING GARDEN  
2023-07-11



CHERNOFF THOMPSON  
ARCHITECTS

Marie Sharpe Replacement School + Cultural Center w/Half-Sized Field House - Option 3  
FIELD HOUSE ENTRY GALLERY  
2023-07-11

## Option 4. School with Open Field & attached Cultural Centre



WILLIAMS LAKE REPLACEMENT SCHOOL  
MARIE SHARPE SITE

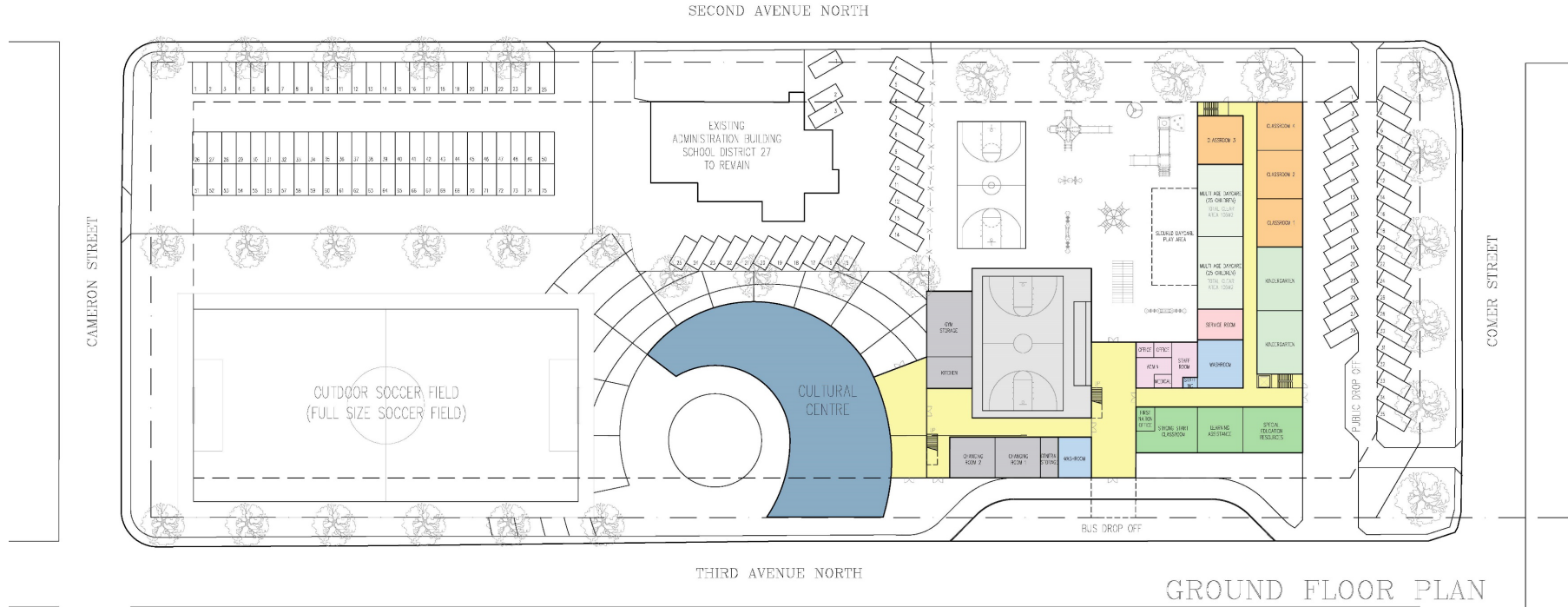
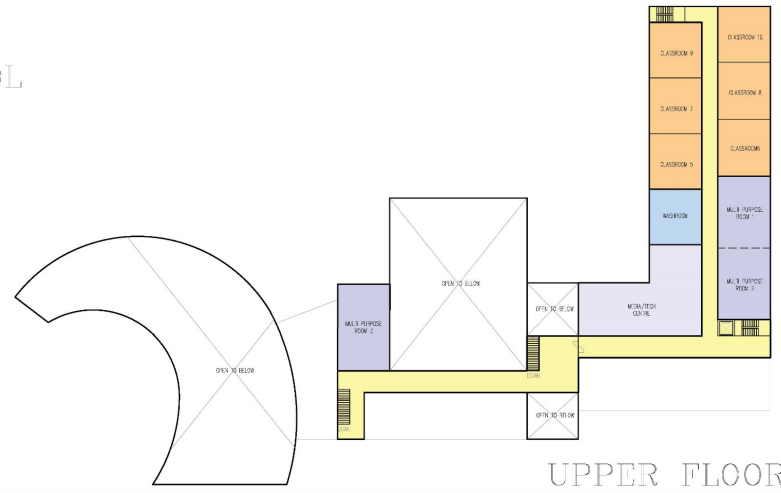
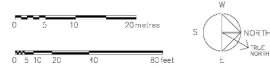



CHERNOFF THOMPSON  
ARCHITECTS

Marie Sharpe Replacement School + Open Field w/Cultural Centre - Option 2  
CULTURAL CENTRE  
2023-06-23



CHERNOFF THOMPSON  
ARCHITECTS

Marie Sharpe Replacement School + Open Field w/Cultural Centre - Option 2  
OPEN FIELD  
2023-06-23

Option 5. School with Open Field & separate Cultural Centre.



# WILLIAMS LAKE REPLACEMENT SCHOOL MARIE SHARPE SITE

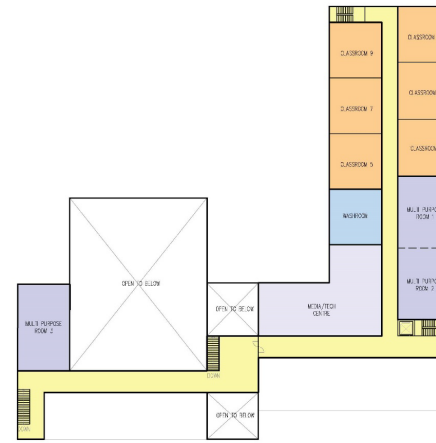
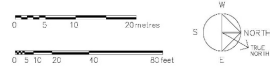

UPPER FLOOR PLAN

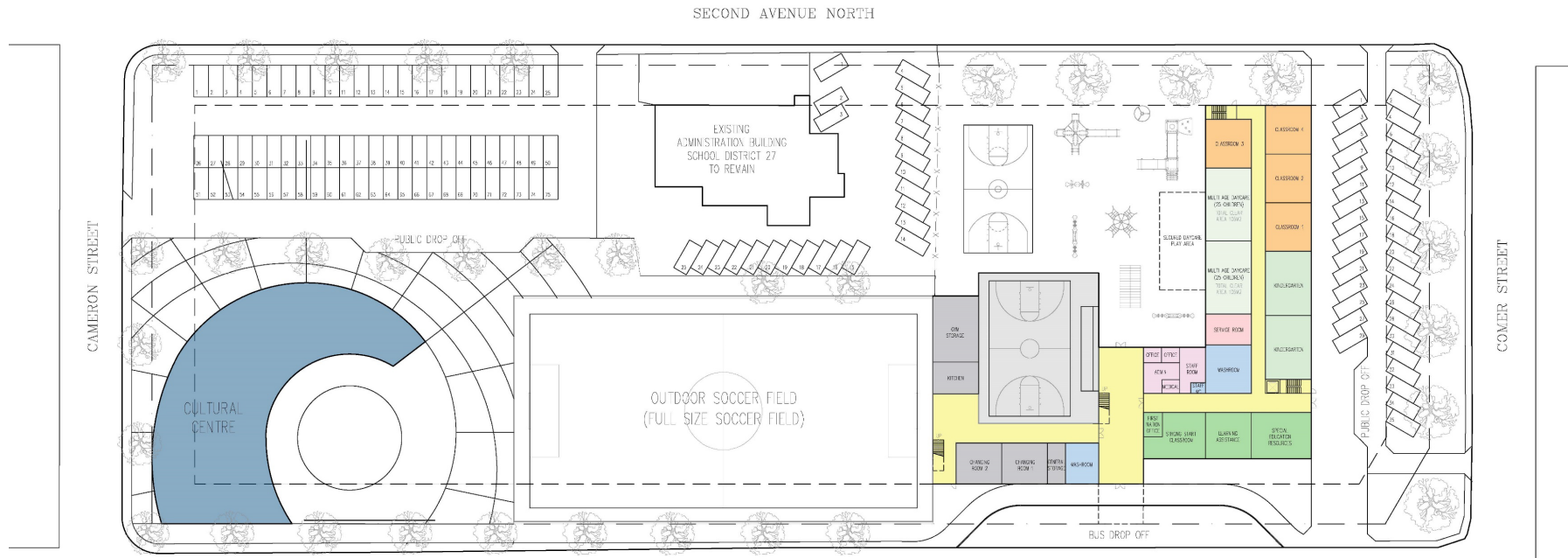

GROUND FLOOR PLAN



CHERNOFF THOMPSON  
ARCHITECTS

Marie Sharpe Replacement School + Open Field w/Cultural Centre - Option 1  
CULTURAL CENTRE  
2023-06-23



CHERNOFF THOMPSON  
ARCHITECTS

Marie Sharpe Replacement School + Open Field w/Cultural Centre - Option 1  
CULTURAL CENTRE & OPEN FIELD  
2023-06-23



Marie Sharpe New School - Com  
munity Engagement



Share your  
feedback and  
complete our  
survey.